



BEFORE YOU BEGIN PLEASE READ THESE SAFETY PRECAUTIONS

- Consult professional help if you are unfamiliar with removing/installing bathroom cabinetry and working with associated plumbing hardware and tools.
- Installing a vanity cabinet and vanity top will require more than one person to do the job.

Vanity Cabinet Installation Instructions

1. Determine vanity cabinet placement. Consider electrical outlets and plumbing requirements. Insure optimum clearances for cabinet doors and drawers, and other clearances such as bathroom entry doors, toilets, and shower/tub openings. **NOTE:** *our white thermo-foil cabinets and the EUREKA style have full overlay drawers, that is the drawer front extends nearly flush to the sides of the cabinet. Special attention is needed when placing these cabinets against a side wall where the bathroom door's trim casing may prevent drawers from fully opening. A fill strip or different drawer configuration may be necessary.*
2. Be sure that the floor is level. If necessary, shim bottom of cabinet so that the back is flush against the wall.
3. Locate wall studs. Attach cabinet to the wall at stud locations (screw through the cabinet wall brace into a wall stud).
4. Doors can easily be adjusted (if out of alignment) by loosening hinge screws attached to the face frame, adjusting and re-tightening screws.
5. Door and drawer knobs on applicable cabinets are located in a bag taped around the wall brace.

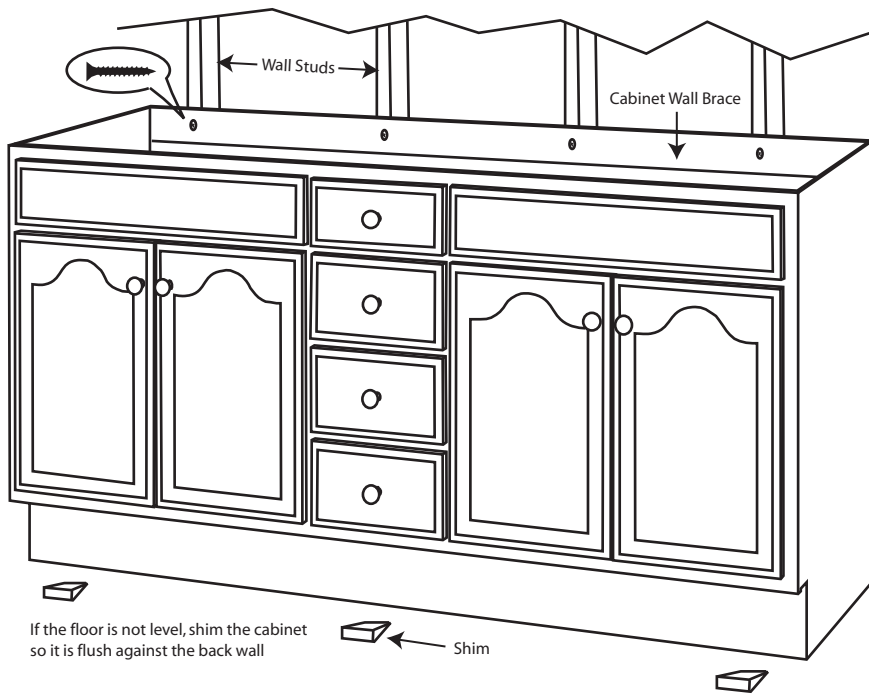

All Wood Changes Color

When trees are milled, the resins and sugars dry into the lumber and veneers. As wood ages and is exposed to light, these resins and sugars change color, thus affecting the color of the wood. Color changes are more noticeable when wood has a lighter stain. Over time, maple and oak tend to yellow, while cherry tends to darken. New cabinets will never be the same color as an aged sample or bathroom display.

The Only Thing Consistent About Wood Is That It Is Inconsistent

The natural beauty and distinctive appearance of wood cabinetry is derived from the inherent qualities of wood itself. Variations like grain pattern and unique markings such as dark mineral streaks can be present from cabinet to cabinet and within the same door/drawer front. THESE ARE NOT DEFECTS. Within any bathroom setting you can expect variations which distinguish the beauty of wood. Each cabinet is only a small piece of nature's work of art!

Care and Cleaning Instructions

USE: For wood cabinets use a quality furniture spray polish like Old English®. To maintain the finish of your white vanity cabinets we recommend a damp cloth with mild soapy water (OR) mild all purpose cleaners without amonia.

DO NOT USE: Strong solvent based cleaners, paint thinners, mineral spirits, etc. any waxes or polishes that contain silicone amonia or any product that contains amonia.